

Assembly Instruction Field Serviceable/Installable

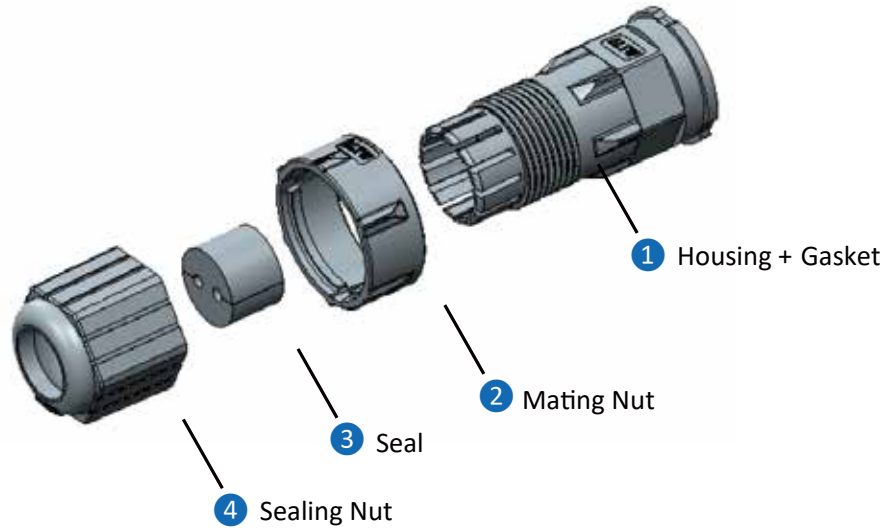

1

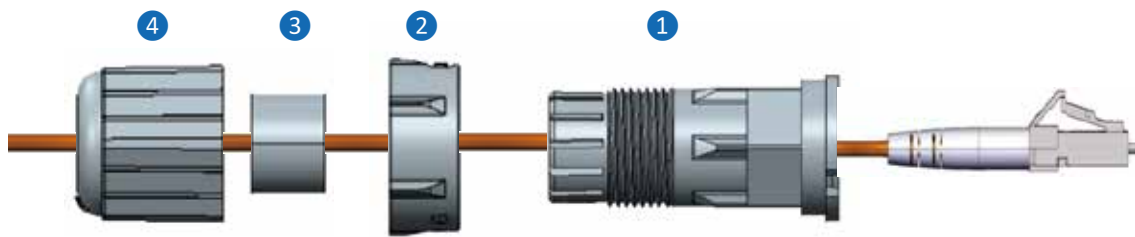

Follow the order from ④ to ① and put components through cable accordingly, no need to assemble here.

2

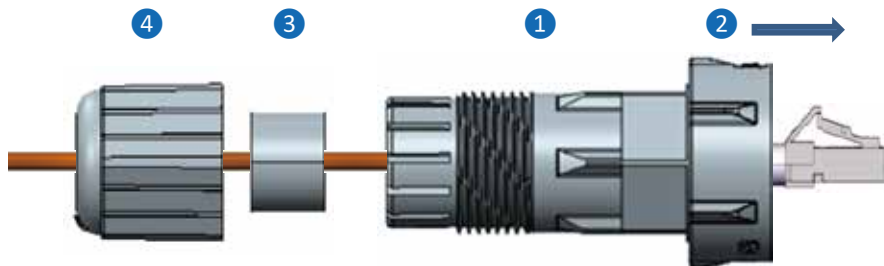

Assemble components ② → ① first

3

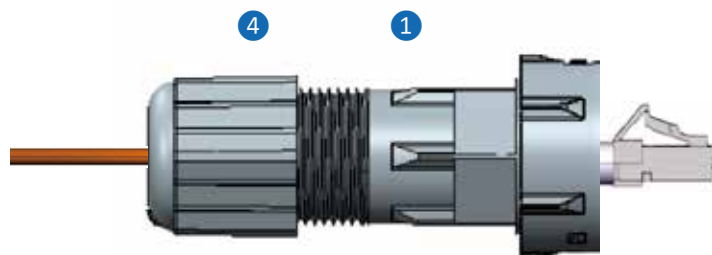

Then assemble ③ → ①, ④ → ①) and follow the torque force accordingly.

	① & ④
Torque Force (Unit: kgf-cm)	8.0 ~ 15.0